

# MOVE3

O&M Manual

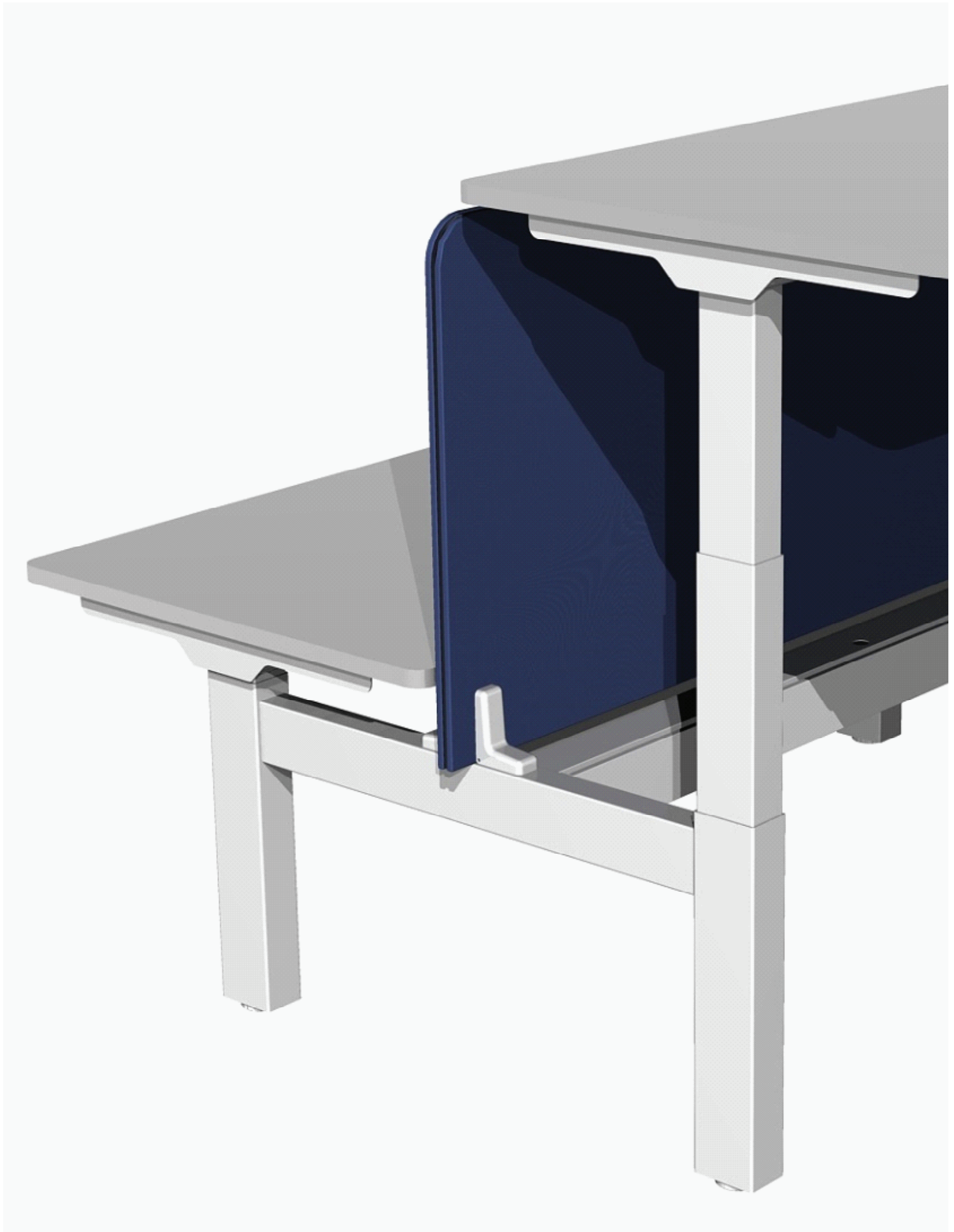

# Move3 Range

Finishes & Materials

The Move3 range gives the user extra height adjustability and is available as a single desk or bench solution. The part pre-assembled frames reduces assembly time.

- Twin motor system to carry an 80KG load at  
At up to 40mm per second constantly
- Height adjustable range 600mm - 1250mm
- 650mm stroke
- Inset central cable tray with split lift-off/  
hinged lids
- Anti collision, including approximate drive  
back of 40mm
- Memory readout handset as standard
- Different top styles available including: plain,  
port holes, scallops, square and  
radius corners
- Warranty: 5 years fixed,  
2 years moving parts
- Individual top mounted cable tray option
- Wide central frame fixed cable tray option
- Cable chain option (low tray to top)

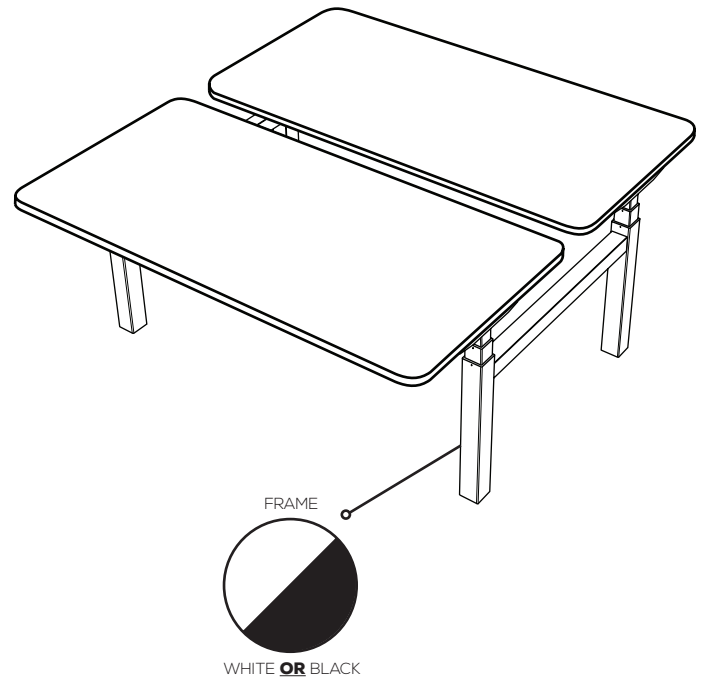

## Materials

- 25mm MFC Tops with ABS edging
- Powder coated steel frame (available in white or black)

## DESK OPTIONS

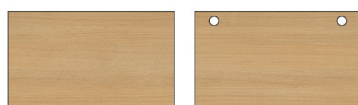

All MFC desk tops are available with matching edging as standard or Multiplex Edging as an option

## DESK FINISHES



# Single Desk

Dimensions

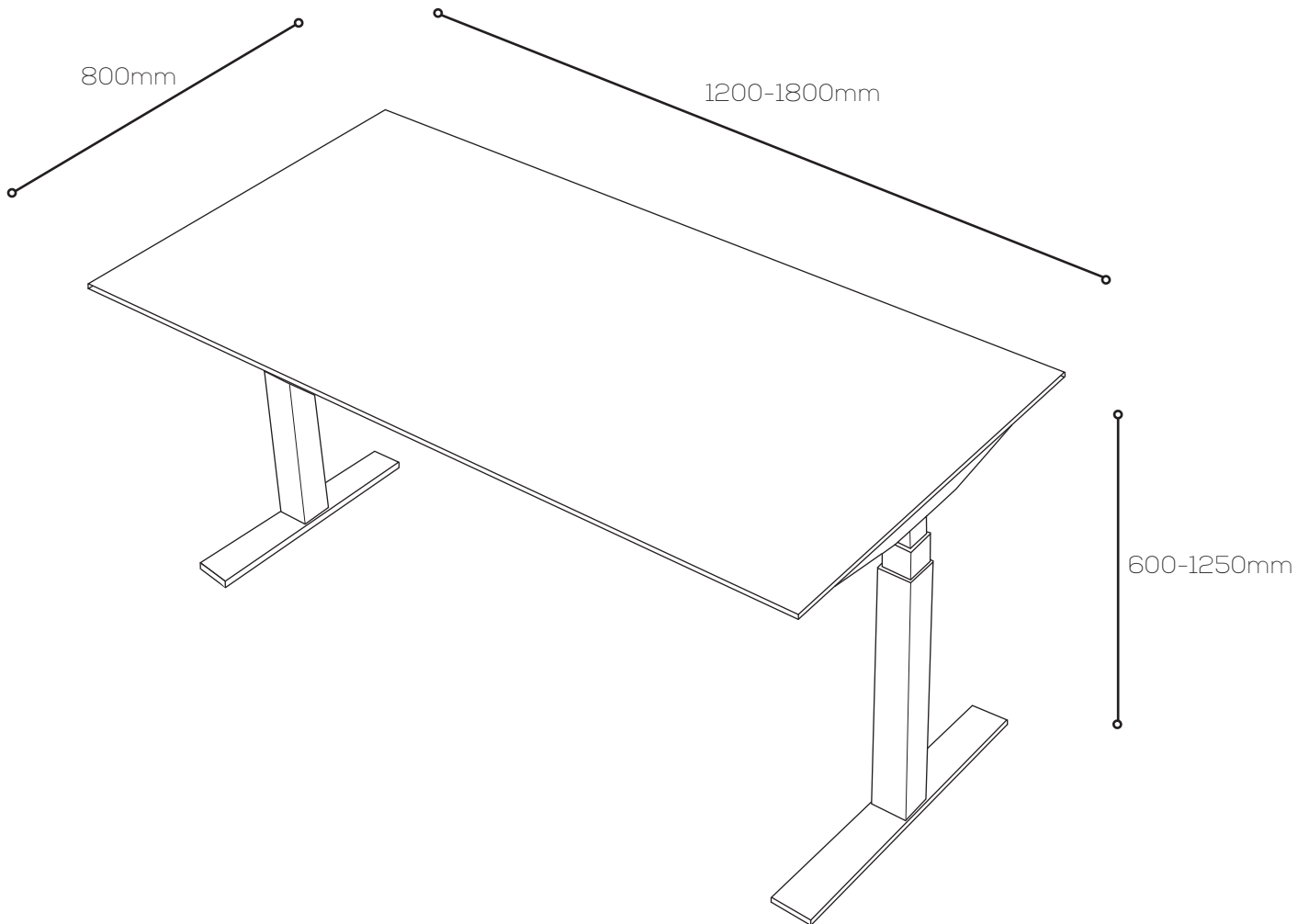

# Back to Back Desks

Dimensions

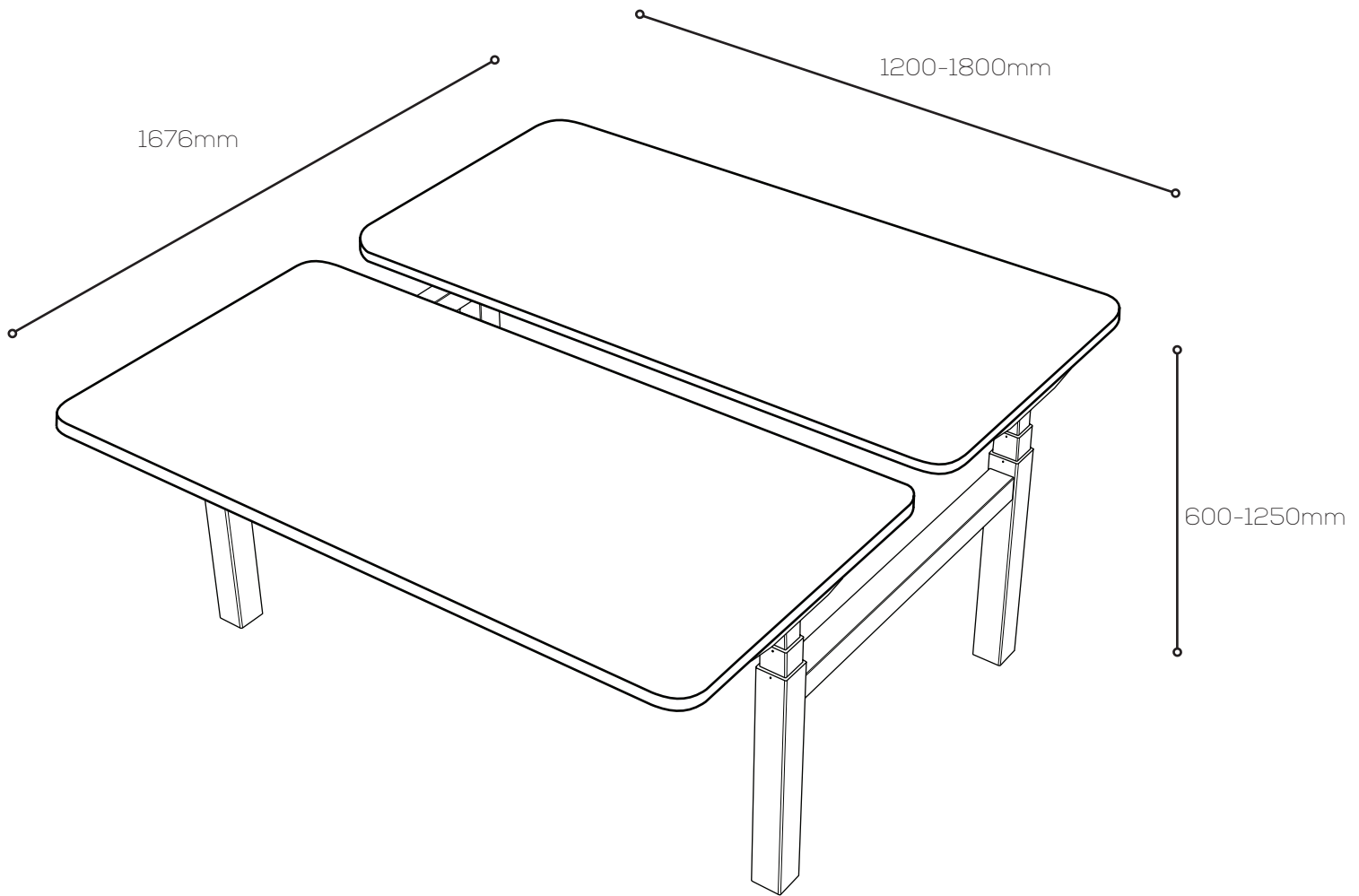

# Screen Bracket

General Information

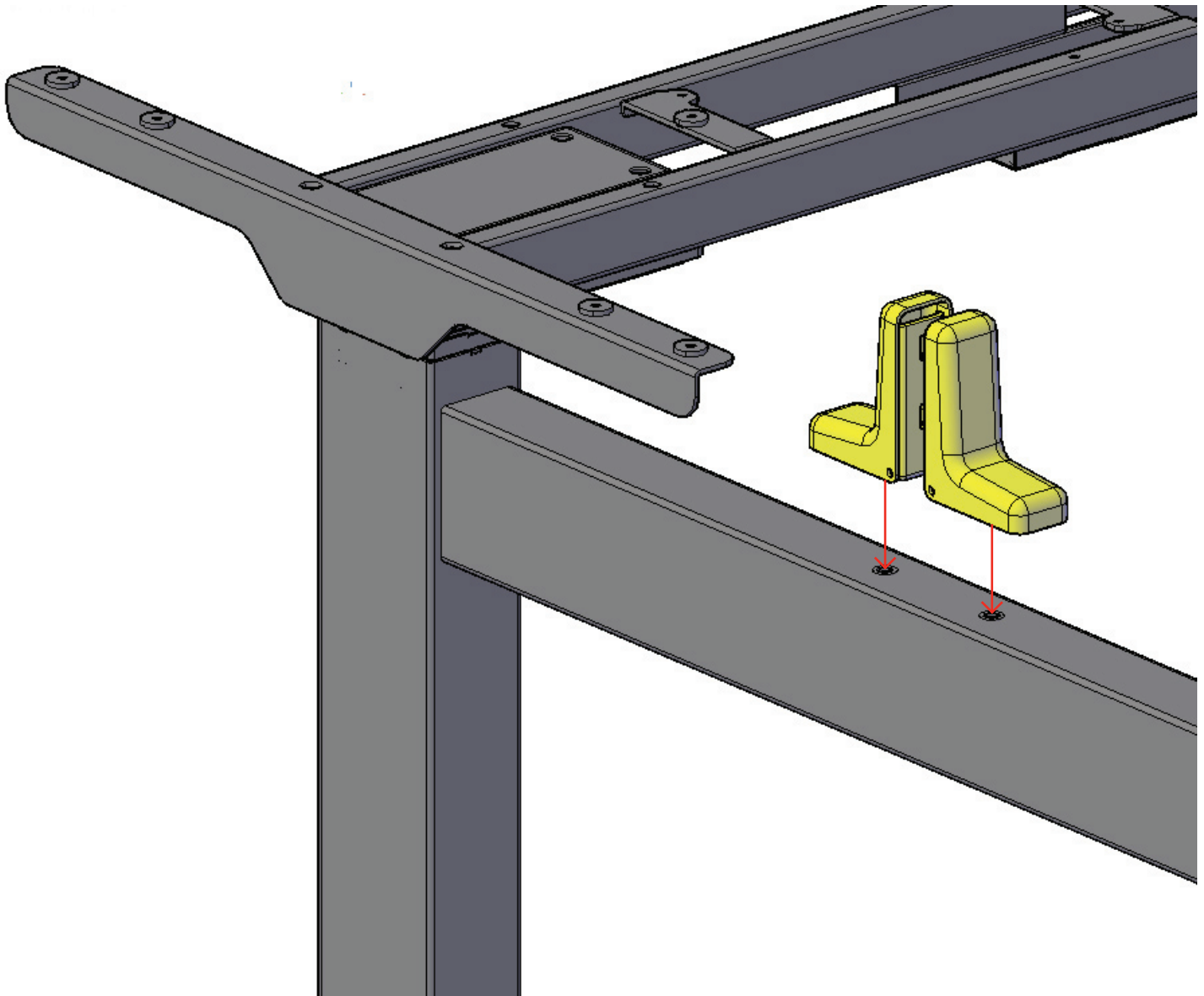

Universal screen bracket  
for use with S1, S2 and S4  
screens.

# Handset Controls

## Operating Instructions

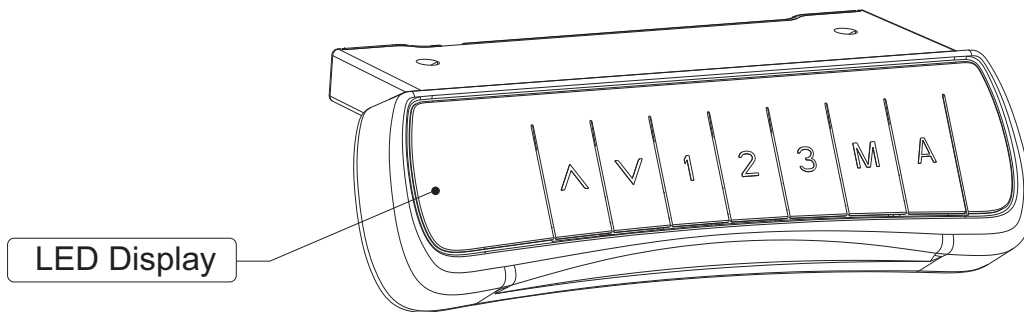

### Product Specification

Button introduction: There are seven buttons that "▲", "▼", "1", "2", "3", "M", "A"

- (1) "▲" : Adjust the desk upwards
- (2) "▼" : Adjust the desk downwards
- (3) "1" : Position 1, first height position saved by the user
- (4) "2" : Position 2, second height position saved by the user
- (5) "3" : Position 3, third height position saved by the user
- (6) "M" : Height memory function
- (7) "A" : Alert button to remind users changing posture

### Operating Instructions

#### Height Adjustable Function:

Press the "▲" Or "▼" Button to adjust the height. The LED display shows the current Height.

#### Height Memory Function:

- A: Press UP or DOWN button and adjust the height to the desired height. Press "M" to save the height, and the screen will display "S-";  
Press "1", "2", or "3" then, that is, save the height to the corresponding position 1 or 2 or 3, which will show in the display screen as "S-1", "S-2", or "S-3";
- B: Press "1", "2" and "3" button directly to automatically adjust the memory height you saved.

# HANDSET CONTROLS

## Operating Instructions

### Reminder Function:

- A: Press REMINDER button "A" to activate the function. The LED display shows "ON" or .
- B: Two seconds later, press the "▲" or "▼" button to adjust the reminder time only when the display screen flashes. The default time of the reminder is 45 minutes, which is shown as "45". Then press any button to save the time setup, or wait 5 seconds and system will save the time setup automatically. During the countdown, any operation will lead to a repeat starting of the timer. When the countdown finishes, display screen will show "00" the buzzer will be active with a 10-second "DiDi...DiDi...DiDi..." tone.
- C: Within the 10-second reminder buzz, press any button to reactivate the time countdown that is set up in (B) step. If no operation during the 10-second reminder buzz, there will be another reminder buzz after 5 minutes. No operation during the second buzz will turn off the Long-Time Sitting Reminder.
- D: Press and hold the "A" button for three seconds to turn off the Long-Time Sitting Reminder. The LED display shows "OFF" or "off".

### Anti-collision sensitivity adjustment - optional features:

- A: Press and hold the "▲" "▼" button for 5 seconds at the same time to switch the sensitivity. Switch one level for 1 time and divide it into **4 levels** (A-3, A-2, A-1, A-0);
- B: The display shows "A-0" , the anti-collision function is off; the display shows "A-1", low sensitivity; Display shows "A-2", medium sensitivity; display shows "A-3", high sensitivity; (factory default is A-3);
- C: During height adjustment, when tabletop comes in contact with another object, it instantly stops and reverses to avoid damage.
- D: Press and hold the "▲" "▼" button for 5 seconds at the same time. If the display does not display the above code, there is no anti-collision function.

### Troubleshooting:

- A: When the LED display shows "ASR" or "rSt", long press the down key "▼" , the standing desk runs to the lowest or highest position and then runs in reverse until it stops, at this time the display shows the height number, release the down key "▼", After the reset, the desk can be used normally;
- B: When reporting the error code, short press the down key "▼" to enter the "ASR" or "rSt" state and perform the reset operation;
- C: If you perform the above operations, the desk still does not work properly, please contact customer service.

# Single Desk Assembly

Assembly Instructions

Item No.: ZM3TSGLF

Installation guide

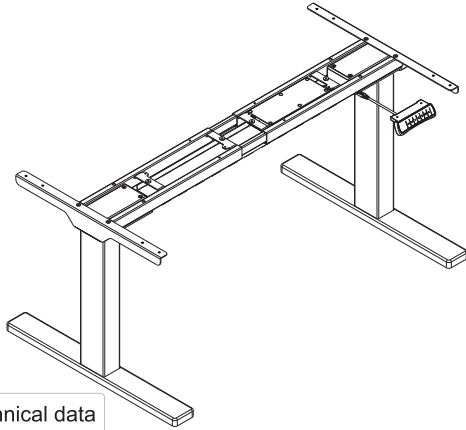

Technical data

Column Stage	3
Max. Weight Capacity	125KG
Height Range	580-1230mm(Without desk board)
Width Range	1100-1900mm

## Accessory list

Attention: The drawings below are for guidance only and they may differ slightly from the product and fittings received. Please contact our customer service department should you have any queries.

No.	Image	Spec	Qty
A		M6	4
B		M6	4
C		M8	8
D		M6	12
E		St4.2	16
F		Allen Key : 4x4mm ; Allen Key(With Cross) 5x5mm	1
G		Cable clamps	4
H		M6	8

## Component list

No.	Part	Qty	No.	Part	Qty
①	Feet	2	②	Lifting Column	2
③	Cable Management Tray	1	④	Supporting Beam	1
⑤	Side Bracket	2	⑥	Hand Switch (Option)	1
⑦	Power Plug	1			

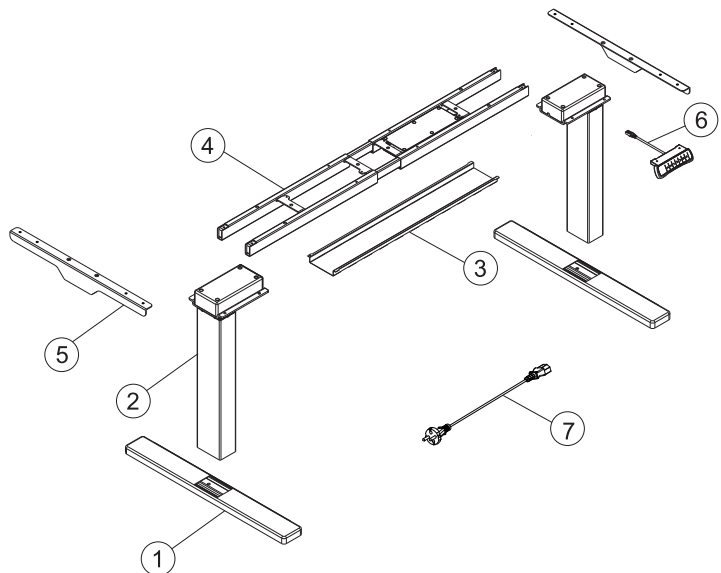

# Single Desk Assembly

Assembly Instructions

## STEP 1

Install the Side Brackets

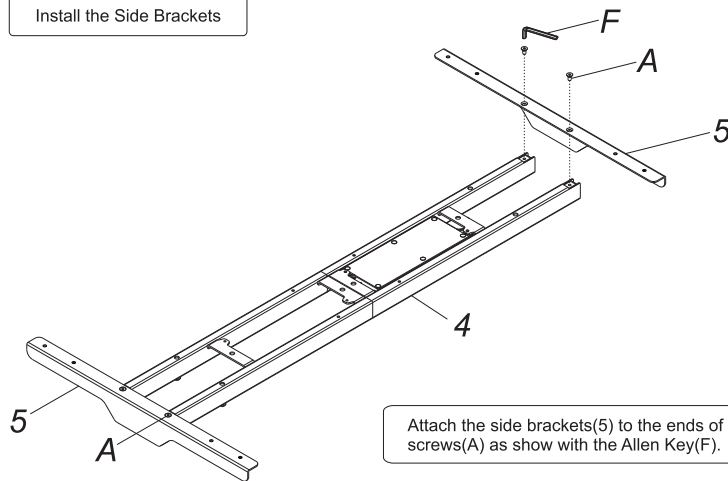

Attach the side brackets(5) to the ends of the supporting beam (4) using screws(A) as show with the Allen Key(F).

## STEP 2

Install the Lifting Columns

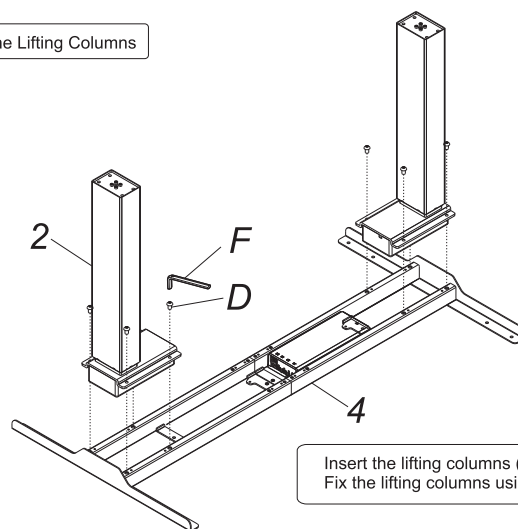

Insert the lifting columns (2) into the ends of the supporting beam(4). Fix the lifting columns using screws(D) with the Allen Key(F).

## STEP 3

Install the Feet

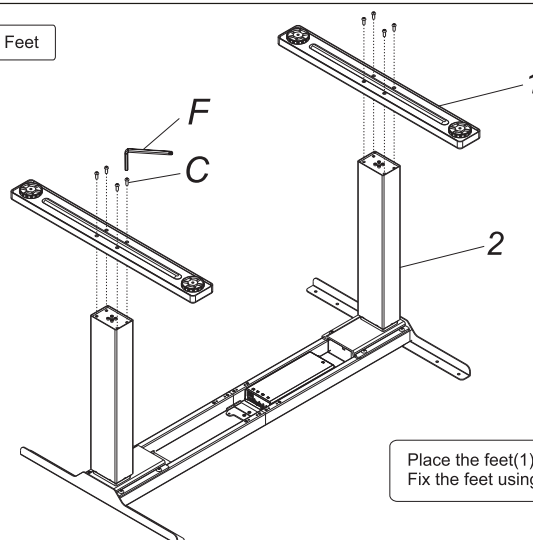

Place the feet(1) on the bottom of the lifting column(2). Fix the feet using screws(C) with Allen Key(F).

# Back to Back Assembly

Assembly Instructions

Item No.: ZM3TBBLF

Installation guide

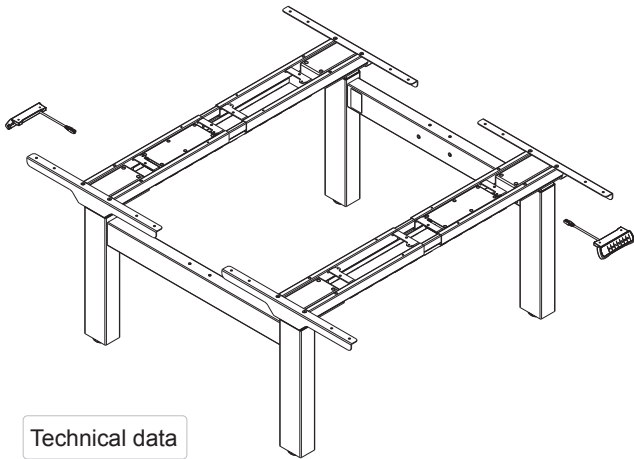

### Technical data

Column Stage	3
Max. Weight Capacity	125KG
Height Range	580-1230mm(Without desk board)
Width Range	1100-1900mm

### Accessory list

Attention: The drawings below are for guidance only and they may differ slightly from the product and fittings received. Please contact our customer service department should you have any queries.

No.	Image	Spec	Qty
A		M6	4
B		M6	4
C		M6	12
D		St4.2	16
E		Allen Key 4x4mm	1
F		Cable clamps	4
G		M6	8

Note: there are 2 screw packages in total.

### Component list

No.	Part	Qty	No.	Part	Qty
①	Left Lifting Column	2	②	Right Lifting Column	2
③	Cable Management Tray	2	④	Supporting Beam with control box	2
⑤	Bracket	4	⑥	Hand Switch	2
⑦	Power Plug	2			

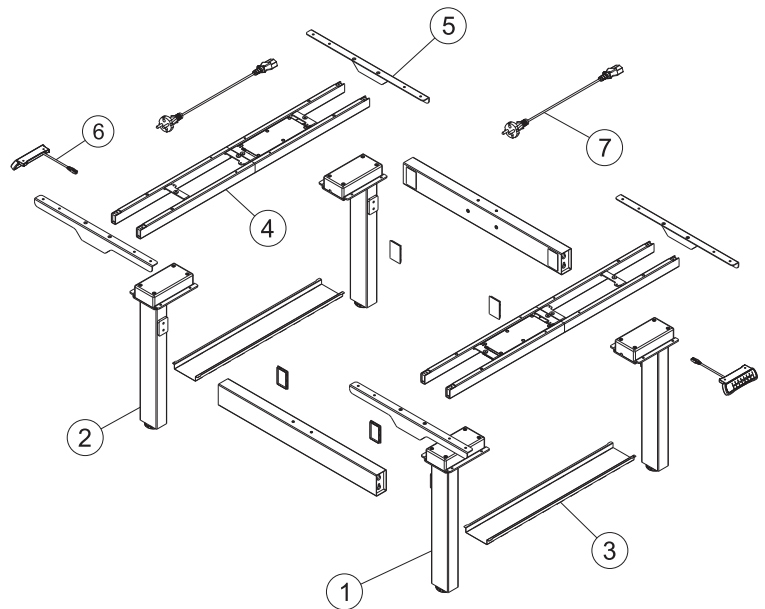

### Matching Parts

Part	Qty	Part	Qty
Leg Beam	2	Decorative cover	4

	M8	8
	Wrenches	1

# Back to Back Assembly

Assembly Instructions

## STEP 1

Install the Lifting Columns ( 1 ) ( 2 )



! Please pay attention to the left or right of lifting columns

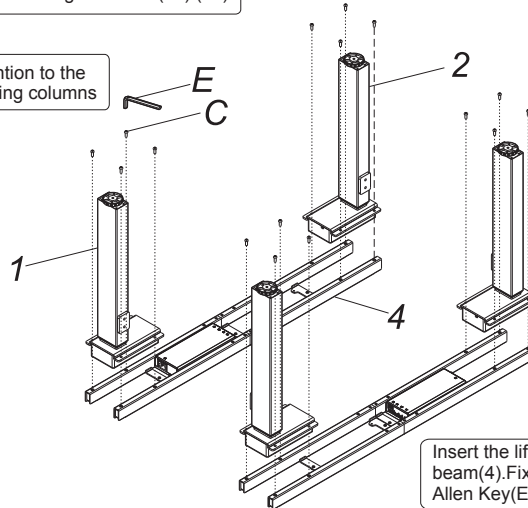

Insert the lifting columns( 1 )( 2 ) into the ends of the supporting beam(4).Fix the lifting columns using screws(C) with the 4X4 Allen Key(E).

## STEP 2

Install the leg beam



! Note the beam orientation.

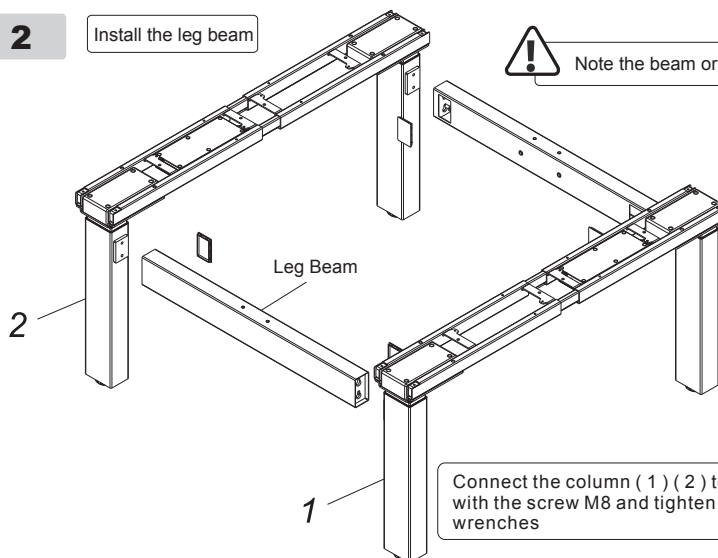

Connect the column ( 1 ) ( 2 ) to the leg beam with the screw M8 and tighten it with the wrenches

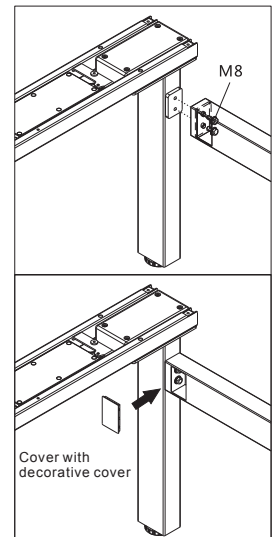

Cover with decorative cover

## STEP 3

Install the supporting beam(5)(6)

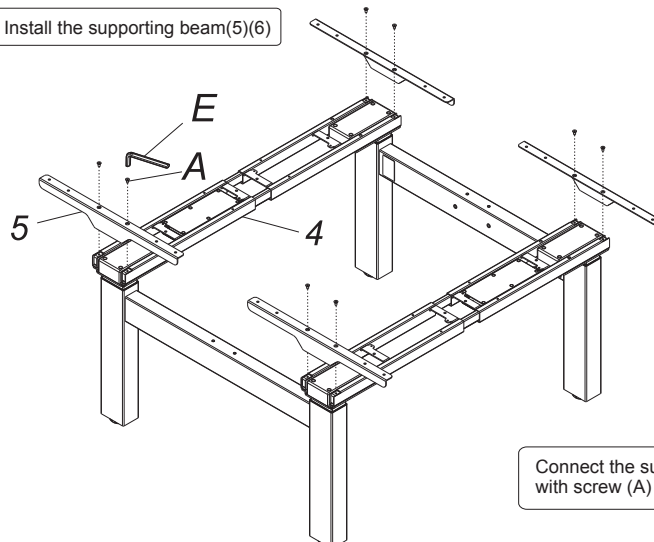

Connect the support beam ( 4 ) to the support plate ( 5 ) ( 6 ) with screw ( A ) and tighten it with 4 x 4 wrench ( E ).

For general cleaning, and for the removal of light dirt or deposits, wash the laminate using a soft damp cloth and a mild nonabrasive soap. Then rinse clean with a damp cloth and then dry using a soft cloth. Most stubborn stains including grease, varnish or paint may be removed when rubbed gently with a white spirit. Then rinse clean with a damp cloth and then dry using a soft cloth. Highly concentrated fruit and vegetable juices must be wiped off immediately as some could cause permanent staining.

## How to avoid streaks?

Streaks often form when the surface is cleaned with organic solvents, together with cold water and old cloths. To ensure no streaks occur when cleaning, we recommend wiping the surface down with warm water and then drying it using normal paper towels or microfibre cloths.

## The following cleaning agents should not be used under any circumstances:

- Scouring and abrasive agents (abrasive powders, scouring pads, steel wool)
- Polish, washing powder, furniture cleaner, bleach
- Detergents with strong acids and acidic salts
- Steam cleaning equipment

## Painted Metalwork

For general cleaning, wash painted metal finishes with a soft, lint free cloth, soaked in warm water and a mild non-abrasive soap. Rinse thoroughly and dry. Scuff marks can be removed using a pre-softened paste wax carefully following the manufacturers instructions

## Servicing

- No user serviceable parts. Only skilled operatives to work on the product.
- To ensure smooth running of the moving parts, periodically clean the telescopic leg sections with a dry cloth to avoid a build-up of dust.
- Periodically (e.g. once a year) check and tighten all bolts.
- Telescopic leg components are self-lubricating. No additional lubrication is required, and should not be applied.